

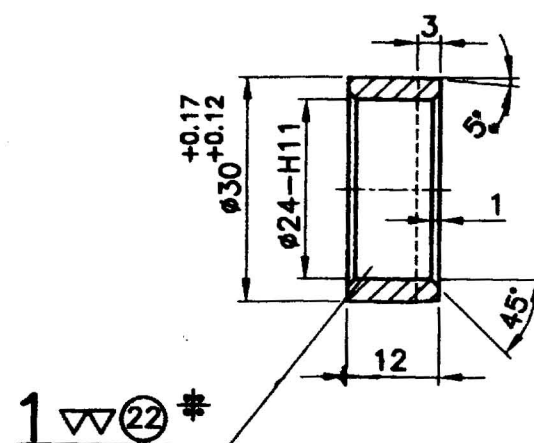

CDA: -Sd- 08.06.72



☒ 2. ALTERNATIVELY NYLON BUSH TO DRG.NO.EMU/M-3-2-060
ITEM-7 MAY BE USED.

* CASE HARDENED TO A DEPTH OF 0.5mm
HARDNESS 50 TO 60 HRC. (ROCKWELL)

* EMU/M, DC/EMU/M



DESCRIPTION OF JIG/TOOL No.	JIG/TOOL No.	▽ ROUGH MACHINED	②1 ROUGH CLEANING	ALTERATIONS
		▽▽ FINISH MACHINED	①⑧ CHAMFERED	⑨ 2/72 MAT.SPEC.OF ITEM-1 ALTD.FROM SLC16-81 TO IRS M4-CL1 QTY OF ITEM-1 IN COL1 ALTD.FROM 96 TO 112. ASSY.DRG.NO.EMU/ M-0-3-066 ADDED.
		▽▽▽ FINE FINISH MACHINED	②② CASE HARDENED	CDA: -Sd- 18.02.72
ALT	DATE	CHANGES	BY/APP	① 8/92 NOTE-1 ADDED. SD: -Sd- 03.08.92
M3	16/05	MATL. SPECN. STOCK NO. CHANGED. ECN.No. 90600366.	[Signature]	① 8/2000 DRAWING REDRAWN IN CAD. REF.DRG.&MAT.SPEC.ALTD.FROM IS:7270-74 SL37.TAB-1&2 AND IS:4432-67 C14 TO IS:9550-80 TAB-2, Gr.1&S:1875-92-CL1 RESPLY. R.M.SIZE ALTD.FROM #36 TO #32. NOTE1 DELETED& NOTE 2 ADDED. SSE/D: [Signature] SME/BD
				② 6/72 MAT.SPEC.FOR ITEM-1 ALTD.FROM IRS-M4 CL1 TO SLCL4 IS:1875 (70) AND RAW MATERIAL SIZE #40 ADDED IN THE REMARKS COL CASE HARDENING DELETED CDA: -Sd- 16.06.72
				③ 5/76 MAT.SPEC.ALTD.FROM SLCL4: IS: 1875(70) TO IS:4855-68 C-14 AND R.M.SIZE ALTD.FROM #40 TO #35 CDA: -Sd- 25.05.76
				④ 2/77 MAT.SPEC.ALTD.FROM IS:4855- 68 C14 TO IS:2073-10C14 AND IN REMARKS COL.#35 ALTD. TO #36. CDA: -Sd- 16.02.77
				⑤ 8/78 NOTE FOR HEAT TREATMENT ADDED. CDA: -Sd- 27.06.78
				⑥ 3/84 MAT.SPEC.ALTD.FROM IS:2073-70 C14 TO IS:4432-67C14 AND IS:7283-74. CDA: -Sd- 05.03.84
				⑦ 11/84 MAT.SPEC.ALTD.FROM IS:7283-74 & IS:4432-67-C.14 TO IS:7270 -74 SL37 TAB 1&2 &4432-67 -C14. CDA: -Sd- 15.11.84

NOTE :

1. ~~ALTERNATIVELY ACETAL RESIN BUSHES TO DRG.NO.EMU/M-3-2-061-
ITEM-7 MAY BE USED.~~

2. ALTERNATIVELY NYLON BUSH TO DRG.NO.EMU/M-3-2-060
ITEM-7 MAY BE USED.

* CASE HARDENED TO A DEPTH OF 0.5mm
HARDNESS 50 TO 60 HRC. (ROCKWELL)

[illegible]

FORM A3 420 * 300